



# BRO Equalizing Assembly

Used in conjunction with a "R / RN" lock mandrel to hold differential pressure from above below the plug assembly in the wellbore.

Designed to be installed or retrieved in a single run application.

The collet is actuated by probes attached to the running or pulling tools.

The R equalizing assembly is typically used in higher pressure scenerios as the lock mandrels and equalizing assemblies are designed to faciltate higher working pressures.

**Applications:**

Used during routine maintance of the wellbore, typically to suspend production, or preform maintance on the wellbore.

Used to blank the production tubing off during the installation of workover BOP

Used when there may be a sand or debris issue that would hinder conventional plugs that require the use of multiple runs or utilize equalizing prongs such as PR Plug.

Used to retrieve tubing from the wellbore during snubbing operations.

BRIO-TECH PRESSURE CONTROLS

Size	1.71"	1.78"	1.87"	2.00"	2.125"	2.188"
Over all Length (")	8.25"	8.25"	8.25"	8.25"	8.25"	8.25"
Over all Length mm	209.55mm	209.55mm	209.55mm	209.55mm	209.55mm	209.55mm
Maximum OD (")	1.705"	1.771"	1.865"	1.995"	2.115"	2.18"
Maximum OD (mm)	43.31mm	44.98mm	47.37mm	60.67mm	53.72mm	55.37mm
Upper Thread Conn.	1.125-16UN	1.375-14UN	1.375-14UN	1.375-14UN	1.375-14UN	1.75-12UN

Size	2.31"	2.56"	2.75"	2.81"	3.43"	3.688"
Over all Length (")	8.25"	8.25"	8.25"	8.25"	8.25"	8.25"
Over all Length mm	209.55mm	209.55mm	209.55mm	209.55mm	209.55mm	209.55mm
Maximum OD (")	2.30"	2.55"	2.74"	2.80"	3.42"	3.680"
Maximum OD (mm)	58.42mm	64.77mm	69.59mm	71.12mm	86.87mm	93.47mm
Upper Thread Conn.	1.75-12UN	2.00-12SLB	2.25-12SLB	2.25-12SLB	2.75-12SLB	3.062-12SLB

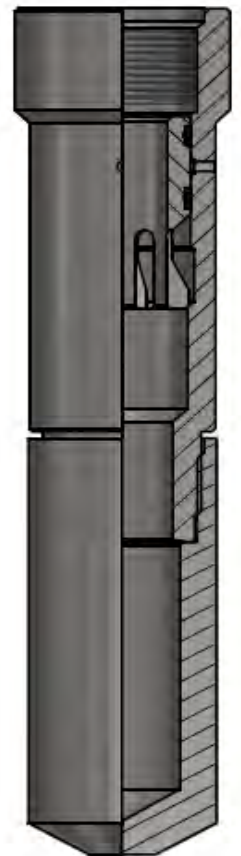

\*Smaller or larger sizes available upon request, as well as custom materials  
Contact your Brio-tech representative for more information

BRIO-TECH PRESSURE CONTROLS - 3904 – 53RD AVENUE NW, EDMONTON, ALBERTA, CANADA T6B 3N7  
(780) 670-2020

PLEASE STATE PART DESCRIPTION AND SIZE WHEN ORDERING

