



Cam Cutter

To cam cutters purpose is to cut or sever wire or cable lodged in the wellbore.

The cam cutter functions by actuating a cam using past a hardened toolsteel cutter block.

The wire or cable is sheared when the cam passes the cutter block

A narrow slot is cut in the cam, bean and two piece to retain the wire or cable, the bean is held in place with shear pins to mitigate premature shearing of the line.

Once the cam cutter impacts a solid obstruction, the shear pins are sheared, the bean actuates the cam and the the line is sheared between the cutter block and the cam.

The body O.D. measurements are affected by the tubing size, threaded guides may be utilized on the drop bars of the cam cutter.

Applications:

Cutting wireline, slickline, or cable at the top of a rope sockets that may have become stuck in the wellbore.

Cutting wireline, slickline, or cable from the top of Go-Devils in the wellbore.

Size	1.625"
Upper Thread	0.938-10UN
Fishneck dropbar (")	1.375"
Fishneck (mm)	34.93mm
Over all Length (")	8.00"
Over all Length (mm)	203mm
Drop Bar Length	18" / 3' / 5'
Drop Bar Length (cm)	45 / 91 / 152
Maximum OD (")	1.625"
Maximum OD (mm)	41.23mm

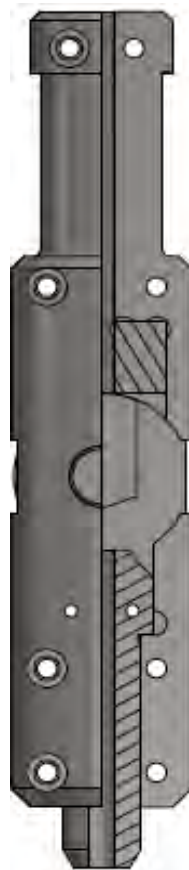

Available with locator rings to centralize in the wellbore
Contact your Brio-Tech representative for more information

BRIO-TECH PRESSURE CONTROLS - 3904 – 53RD AVENUE NW, EDMONTON, ALBERTA, CANADA T6B 3N7
(780) 670-2020

PLEASE STATE PART DESCRIPTION AND SIZE WHEN ORDERING

