



Crossover - QLS

Used for a quick and easy assembly of toolstring equipment without the use of pipe wrenches.
This replaces typical sucker rod connections that may wear over time.

Applications:

Used for typical day to day operations for day to day slickline operations.

Used for operations in coated tubing where burs caused by pipe wrenches may cause damage to coating applies to the tubing string.

Used for quickly changing out tool string equipment during wireline / slickline operations.

Size	1.50"	1.75"	1.875"	2.125"
Fishneck (")	1.75"	1.75"	2.31"	2.31"
Fishneck (mm)	44.45mm	44.45mm	58.67mm	58.67mm
Maximum OD (")	1.875"	2.125"	2.50"	2.75"
Maximum OD (mm)	47.62mm	53.98mm	63.50mm	69.85mm

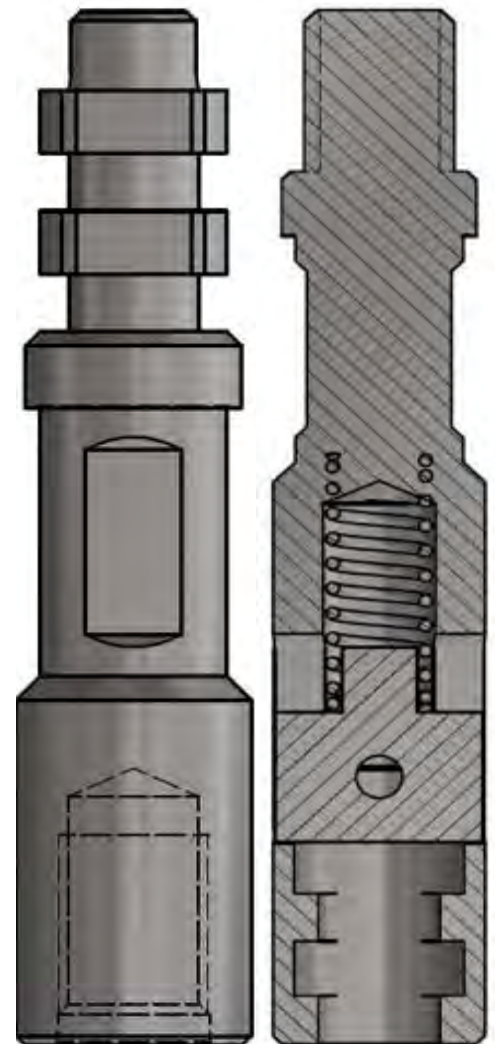

*Alternate thread configurations and sizes available upon request
Contact your Brio-Tech representative for more information



BRIO-TECH PRESSURE CONTROLS - 3904 – 53RD AVENUE NW, EDMONTON, ALBERTA, CANADA T6B 3N7
(780) 670-2020

PLEASE STATE PART DESCRIPTION AND SIZE WHEN ORDERING