



Fishing Clamp - Round

The fishing clamp is utilized when there is a need to secure broken or damaged slickline or wireline at surface either during fishing operations or to repair stranded braided line.

The fishing clamp consists of two rounded plates with inserts that match the size of line being clamped, these plates are tightened or clamped around the line using screws to squeeze the clamps together and secure the line for the type of operation desired.

There is also sucker rod pin that can be attached to the tool string or other device to pull on the damaged line if required.

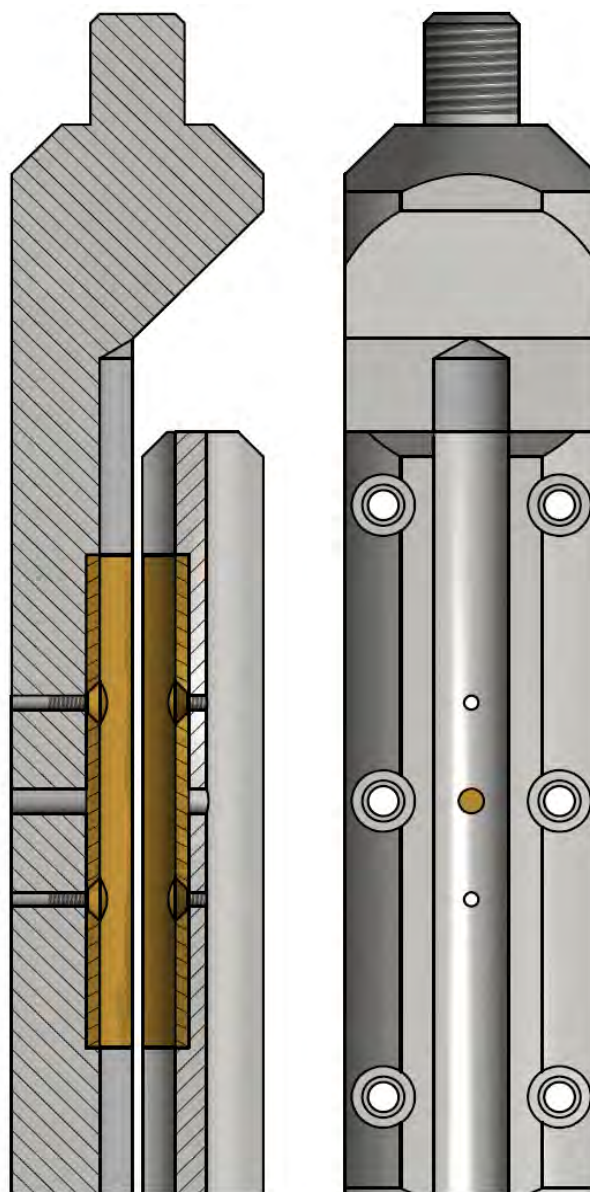

BRIO-TECH PRESSURE CONTROLS

BRIO-TECH PRESSURE CONTROLS - 3904 – 53RD AVENUE NW, EDMONTON, ALBERTA, CANADA T6B 3N7
(780) 670-2020

PLEASE STATE PART DESCRIPTION AND SIZE WHEN ORDERING

