

J Unlatching Head

The J unlatching head is typically used to land bottom hole instruments or other equipment that may be sensitive to downward jar.

The J unlatching head is deployed via the spring loaded J unlatching tool.

The weight of the tool string will actuate the J unlatching tool and release the J head along with the equipment that is being deployed.

Applications:

Landing no-go darts in profile nipples.

Landing bottom hole instruments.

Size	0.75"	1.00"	1.187"	1.375"	2.313"
Fishneck Size (")	0.75"	1.00"	1.187"	1.375"	2.313"
Fishneck Size (mm)	19.05mm	25.40mm	30.15mm	34.93mm	58.75mm
Maximum OD (")	1.00"	1.25"	1.50"	1.75"	2.875"
Maximum OD (mm)	25.40mm	31.75	38.10mm	44.45mm	73.03mm
Lower Thread Conn.	0.50-13 UNC	0.625-11UNC	0.75-16UNF	0.75-16UNF	1.062-10UN

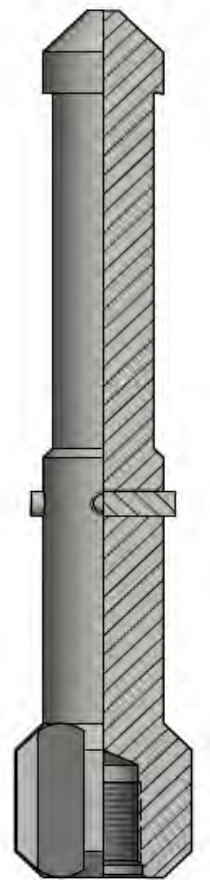

*Contact your Brio-Tech representative for more information

BRIO-TECH PRESSURE CONTROLS - 3904 – 53RD AVENUE NW, EDMONTON, ALBERTA, CANADA T6B 3N7
(780) 670-2020

PLEASE STATE PART DESCRIPTION AND SIZE WHEN ORDERING

