



JK Running Tool

The JK running tool is used in conjunction with a variety of kickover tools to install BK and BK-2 latches into side pocket mandrels.

BRIO-TECH PRESSURE CONTROLS

Size	2 3/8"
Fishneck OD (")	1.188"
Fishneck OD (mm)	30.18mm
Maximum OD (")	1.30"
Maximum OD (mm)	33.02mm
Upper Thread Conn.	0.938-10 UN

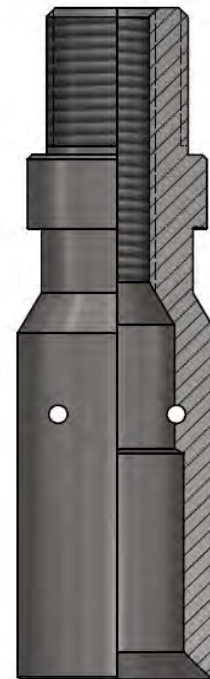

BRIO-TECH PRESSURE CONTROLS - 3904 – 53RD AVENUE NW, EDMONTON, ALBERTA, CANADA T6B 3N7
(780) 670-2020

PLEASE STATE PART DESCRIPTION AND SIZE WHEN ORDERING

