

Landing Nipple - BF

The Baker type BF top no-go selective landing nipple is typically used in wellbore completions that will not see pressures in excess of 5000 psi (35 MPa)

The profiles are typically ran in conjunction with the Baker type BR nipples, with the non selective profiles which are typically placed at the bottom of the tubing string.

Applications:

The F landing nipple can be used to land blanking plugs, flow control regulators sub surface chokes, fluted no-go darts an a variety of other flow control equipment that may required to maintain production, preform bottom hole surveys, or for completion purposes.

| Size | | Weight | | ID | | Drift | | Packing Bore | |
|-------|--------|--------|-------|-------|--------|-------|-------|--------------|-------|
| in. | mm | lb/ft | kg/m | in. | mm | in. | mm | in. | mm |
| 1.660 | 42.16 | 2.30 | 3.42 | 1.380 | 35.05 | 1.286 | 32.66 | 1.250 | 31.75 |
| 1.900 | 48.26 | 2.4 | 3.57 | 1.660 | 42.16 | 1.516 | 38.51 | 1.43 | 36.32 |
| | | 2.76 | 4.11 | | | | | | |
| | | 2.9 | 4.32 | 1.610 | 40.89 | | | 1.500 | 38.10 |
| 2.063 | 52.40 | 3.25 | 4.84 | 1.751 | 44.48 | 1.657 | 42.09 | 1.562 | 39.67 |
| 2 3/8 | 60.33 | 4.6 | 6.85 | 1.995 | 50.67 | 1.901 | 48.29 | 1.625 | 41.28 |
| | | 4.7 | 6.99 | | | | | 1.781 | 45.24 |
| | | | | | | | | 1.813 | 46.05 |
| 2 7/8 | 73.03 | | | 2.441 | 2.00 | 2.347 | 59.61 | 1.875 | 47.63 |
| | | 6.4 | 9.52 | | | | | 2.25 | 57.15 |
| | | 6.5 | 9.67 | | | | | 2.313 | 58.75 |
| 3 1/2 | 88.90 | 9.3 | 13.84 | 2.992 | 76.00 | 2.867 | 72.82 | 2.813 | 71.45 |
| | | 10.2 | 15.18 | 2.922 | 74.22 | 2.797 | 71.04 | 2.750 | 69.85 |
| 4 1/2 | 114.30 | 12.75 | 18.97 | 3.958 | 100.53 | 3.833 | 97.36 | 3.68 | 93.47 |
| | | | | | | | | 3.75 | 95.25 |
| | | | | | | | | 3.81 | 96.85 |

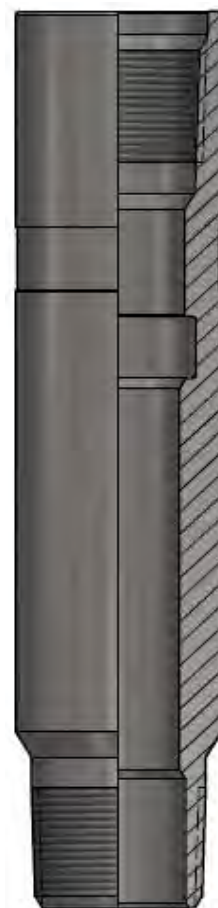

BRIO-TECH PRESSURE CONTROLS - 3904 – 53RD AVENUE NW, EDMONTON, ALBERTA, CANADA T6B 3N7
(780) 670-2020

PLEASE STATE PART DESCRIPTION AND SIZE WHEN ORDERING

