

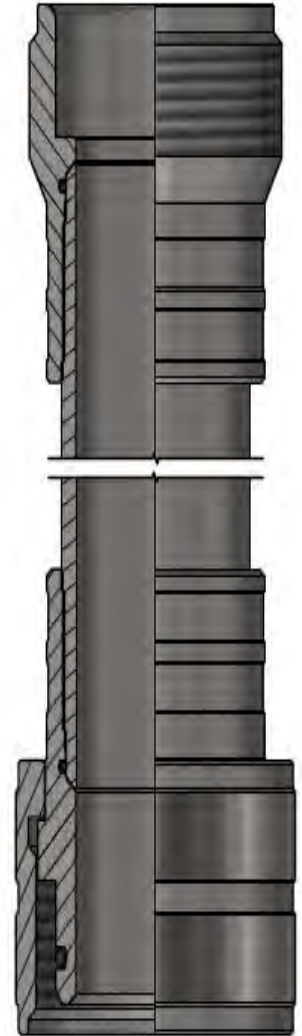

# Lubricator

Lubricator is typically used to house and contain wellbore pressure while performing wireline or slickline operations, this is accomplished with a metal to metal seal, and O-ring back up seals. Lubricator is available in a range of sizes, materials, and thread connections. Lubricator typically comes in 10 foot sections, but can be manufactured to any length required.

BRIO-TECH PRESSURE CONTROLS



\*Smaller or larger sizes available upon request, as well as custom materials  
Contact your Brio-Tech representative for more information

BRIO-TECH PRESSURE CONTROLS - 3904 – 53RD AVENUE NW, EDMONTON, ALBERTA, CANADA T6B 3N7  
(780) 670-2020

PLEASE STATE PART DESCRIPTION AND SIZE WHEN ORDERING

