



# Rotary Line Cutter

The Rotary Line Cutter is used to cut slickline or braided wireline that has become stuck or lodged in the wellbore.

The Rotary line cutter severs the line or cable when a drop bar strikes the top activation mandrel this activates the cutter and crimping mechanism, which in turn severs the slickline or wireline.

The Rotary line cutter crimps to the line when cut and is retrieved with the line from the wellbore.

## Applications:

The Cam line cutter can be utilized should the slickline or wireline tools string becomes lodged in the well bore due to sand, damaged tools, damaged line, or any other situation where the line and toolstring cannot be retrieved via conventional means.

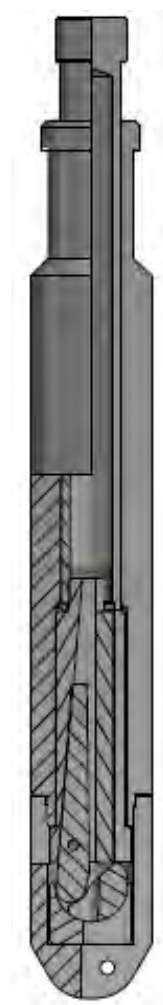

Contact your Brio-Tech representative for more information regarding this equipment.

BRIO-TECH PRESSURE CONTROLS - 3904 – 53RD AVENUE NW, EDMONTON, ALBERTA, CANADA T6B 3N7  
(780) 670-2020

PLEASE STATE PART DESCRIPTION AND SIZE WHEN ORDERING

